



### Products specification

- ◆ BM24R load cells are available in the capacities 10t to 100t .
- ◆ Stainless steel construction, hermetically welded, oil-proof, waterproof and anti-corrosive gas and medium making it suitable for all kinds of environments.
- ◆ Spoke type, suitable for electronic truck scales, automotive testing facilities, hopper scales and other electronic weighing devices and force-measuring fields. also can be used as standard load cell.

### Features

- ◆ Capacity 10t to 100t .
- ◆ High accuracy.
- ◆ Stainless steel construction.
- ◆ Easy installation and reliable performance.

Capacity	t	10/20/47/68/100			
Accuracy class		C2	C3	A5S	A5M
Maximum number of verification intervals	n max	2000	3000	5000	5000
Minimum load cell verification interval	v min	E <sub>max</sub> /5000	E <sub>max</sub> /10000	E <sub>max</sub> /15000	E <sub>max</sub> /15000
Combined error	(%FS)	≤ ± 0.030	≤ ± 0.020	≤ ± 0.018	≤ ± 0.026
Creep	(%FS/30min)	≤ ± 0.024	≤ ± 0.016	≤ ± 0.012	≤ ± 0.017
Temperature effect on sensitivity	(%FS/10°C)	≤ ± 0.017	≤ ± 0.011	≤ ± 0.009	≤ ± 0.013
Temperature effect on zero	(%FS/10°C)	≤ ± 0.023	≤ ± 0.015	≤ ± 0.010	≤ ± 0.014
Output sensitivity	(mv/v)	2.85 ± 0.003			
Input resistance	( Ω )	4450 ± 100			
Output resistance	( Ω )	4010 ± 4			
Insulation resistance	(M Ω )	≥ 5000(50VDC)			
Zero balance	(%FS)	1.0			
Temperature, compensated	( °C )	-10~+40			
Temperature, allowed	( °C )	-35~+65			
Excitation, Recommended	(V)	5~12(DC)			
Excitation, Max	(V)	18(DC)			
Safe overload	(%FS)	150			
Ultimate overload	(%FS)	300			

### Outline Dimension mm(inch)

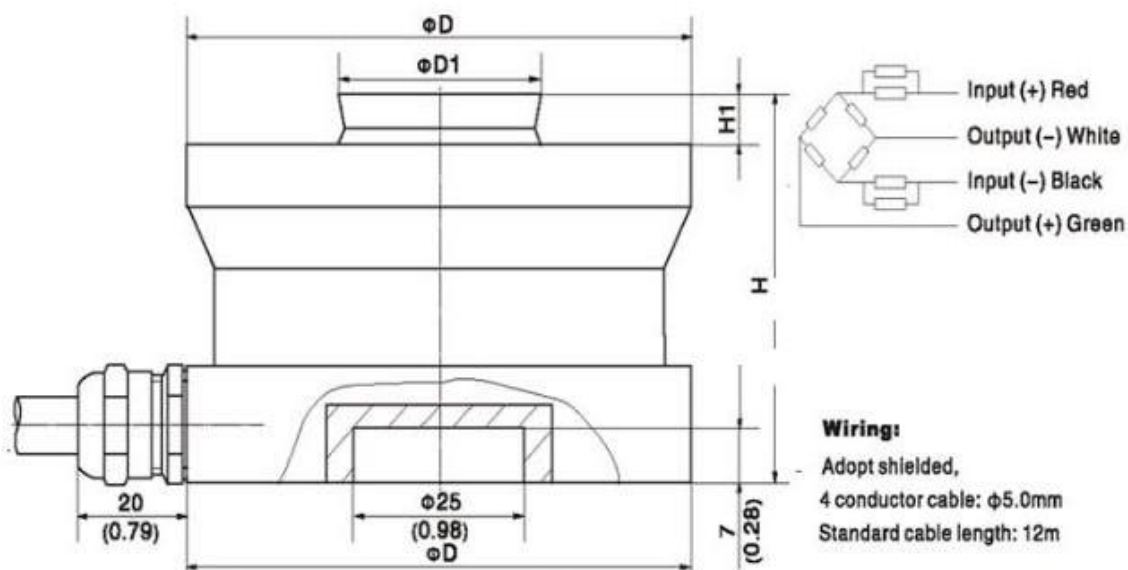

### Wiring:

Adopt shielded,  
4 conductor cable: φ5.0mm  
Standard cable length: 12m

Capacity(t)	D	D1	H	H1
10t,20t	75(2.95)	29.8(1.17)	50(1.97)	6.5(0.26)
47t	130(5.12)	59.8(2.35)	75(2.95)	14(0.55)
68t	130(5.12)	59.8(2.35)	85(3.35)	14(0.55)
100t	150(5.09)	69.8(2.75)	90(3.54)	16(0.63)