

### SPECIFICATIONS

Capacity 50-250kg	Sensitivity 2.0±0.2mV/V	Creep (30 Min) 0.02% F.S.	Input Resistance 406±6Ω
Material Aluminum alloy	Overload Limitation 150% F.S.	Zero Output ±2% Emax	Recommended Excitation 5-12VDC
Protection IP65	Output Resistance 350±3Ω	Temperature Effect Zero 0.17% F.S. / 10°C	Operating Temperature -35-65°C
Accuracy C3	Insulation Resistance ≥5000mΩ (50V)	Temperature Effect Sensitivity 0.014% F.S. / 10°C	

### FEATURES

- M16-OIML/NTEP
- Capacity up to 250kg
- Aluminum alloy material
- Default cable length is 3m, diameter is 5mm  
(Optional customized longer cable)
- Recommended platform: from 300\*300mm to 400\*500mm
- Interchangeable with below models: HMB\* PW10A,  
Mettler Toledo\* MT1241, TedeA-Huntleigh\* 1242, Zemic\* L6Q, Flintec\* PC46



### MODELS

Part No.	120047	120048	120049	120050	120051
M16	50kg	100kg	150kg	200kg	250kg
Class	C3				
IP	IP65				

### DIMENSION / mm(inch)

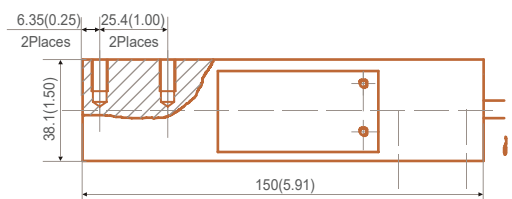
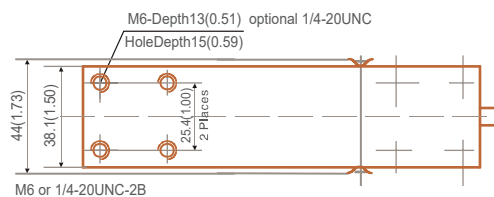
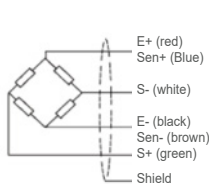

Weight: 0.5kg