

M17P

Single Point Load Cell

Moorange

SPECIFICATIONS

Capacity 10-500kg	Sensitivity 2.0±0.2mV/V	Insulation Resistance ≥5000mΩ	Non-Repeatability ±0.01% Emax.
Material 17-4Ph Stainless Steel	Overload Limitation 150% F.S.	Input Resistance 350±3.5Ω	Recommended Excitation 5-12VDC
Protection IP68 & IP69K	Creep (30 Min) 0.02% F.S.	Output Resistance 350±3.5Ω	Temperature Effect Zero 0.17% F.S. / 10°C
Accuracy C3	Zero Output ±1% Emax	Non-linearity ±0.017% Emax.	Temperature Effect Sensitivity 0.014% F.S. / 10°C
			Operating Temperature -35-65°C

FEATURES

- Capacity up to 500kg
- 17-4Ph Stainless steel material
- Fully welded construction
- Comprehensive mounting holes
- Default cable length is 3m, diameter is 5mm
(Optional customized longer cable)
- Recommended platform: from 250*250mm to 800*800mm
- Interchangeable with below models: HMB* PW15AH (100kg less) ,
Zemic* BM6G, Mettler Toledo* SLP845 (100kg less)



MODELS

Part No.	120093	120094	120095	120096
M17P	10kg	20kg	50kg	100kg
Part No.	120097	120098	120099	120100
M17P-L	100kg	200kg	300kg	500kg
Class	C3			
IP	IP68 & IP69K			

DIMENSION / mm(inch)

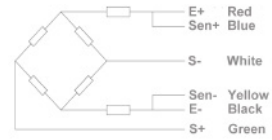

* 10-100kg



Weight: 1 kg

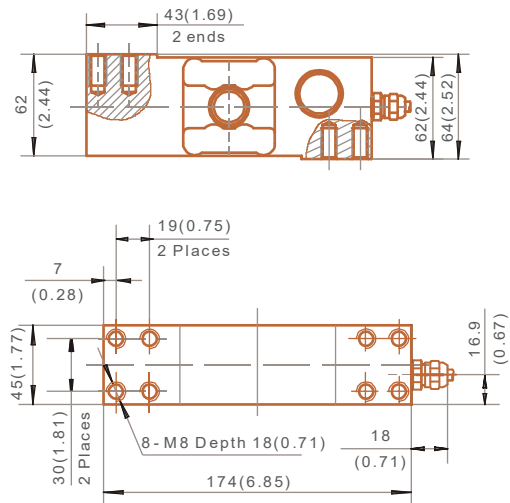

* 100-500kg



Weight: 3 kg

