

### SPECIFICATIONS

Capacity 50-30000kg 100lb-20klb	Accuracy C3/N5	Zero Output ±1% Emax	Recommended Excitation 5-12VDC
Material Alloy steel - M3M Stainless steel - M3S	Sensitivity 2.0±0.004mV/V - M3M 3.0±0.008mV/V - M3S	Insulation Resistance ≥5000mΩ (50VDC)	Temperature Effect Zero 0.017% F.S. / 10°C
Protection IP67	Overload Limitation 150% F.S.	Input Resistance 350±3.5Ω-M3M 430±50Ω-M3S	Temperature Effect Sensitivity 0.014% F.S. / 10°C
	Creep (30 Min) 0.02% F.S.	Output Resistance 350±3.5Ω	Operating Temperature -35-65°C

### FEATURES

- M3M/M3S-OIML/NTEP
- Large capacity up to 30000kg
- Alloy steel or stainless steel material
- Easy to install and maintain
- Suitable for crane scales, hopper scales, etc.
- Default cable length is 4m, diameter is 5mm  
(Optional customized longer cable)
- Interchangeable with below models: HMB\* S35,  
Mettler Toledo\* SLS410, Celtron\*STC, Revere\*363, Zemic\* H3/B3G, Flintec\* PC60



### MODELS

<b>Part No.</b>	120186	120187	120188	120189	120190	120191	120192	120193	120194
<b>M3M</b>	50kg	100kg	200kg	300kg	500kg	750kg	1000kg	2000kg	3000kg
<b>Part No.</b>	120195	120196	120197	120198	120199	120200	120201	120202	120203
<b>M3M</b>	5000kg	7500kg	10t	15t	20t	30t	100lb	200lb	300lb
<b>Part No.</b>	120204	120205	120206	120207	120208	120209	120210	120211	120212
<b>M3M</b>	500lb	750lb	1klb	2klb	3klb	5klb	10klb	15klb	20klb
<b>Part No.</b>	120213	120214	120215	120216	120217	120218	120219	120220	120221
<b>M3S</b>	100kg	250kg	500kg	1000kg	2500kg	5000kg	7500kg	10t	100lb
<b>Part No.</b>	120222	120223	120224	120225	120226	120227	120228	120229	120230
<b>M3S</b>	200lb	500lb	1klb	2klb	3klb	5klb	10klb	15klb	20klb
<b>Class</b>	C3/N5								
<b>IP</b>	IP67								

# M3M

## DIMENSION / mm/inch

\* TE=Efecto Temperatura

Capacidad	L	H	W	T	M	weight/kg
50kg	50.8	76.2	12.7	14.5	M8	0.6
0.1-0.75t	50.8	76.2	19	20.8	M12x1.75	0.6
1-1.5t	50.8	76.2	25.4	27.2	M12x1.75	1
2-5t	76.2	101.6	25.4	27.2	M20x1.5	1.5
7.5-10t	125	175	50	-	M33x3	1.7
15-20t	160	200	60	-	M42x3	2.2
30t	190	230	80	-	M42x3	2.7
100-300lb	50.8	63.5	12.7	15.9	1/4-28UNF	0.6
0.5-1.5klb	50.8	63.5	19.05	22.25	1/2-20UNF	0.6
2-2.5klb	50.8	63.5	25.4	28.6	1/2-20UNF	0.8
3klb	50.8	101.6	25.4	28.6	1/2-20UNF	1.3
5-10klb	76.2	101.6	25.4	28.6	3/4-16UNF	1.3
15klb	101.6	139.7	31.75	34.95	1-14UNF	4
20klb	127	177.8	50.8	54	5/4-12UNF	7

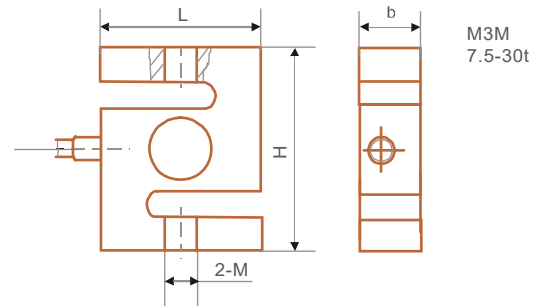

# M3S

## DIMENSION / mm/inch

5klb with 3/4-16UNF

Capacidad	Capacidad	L	H	W	T	M	weight/kg
50-100kg	50-300lb	50.8	60.96	11.68	15.06	M8 1/4-28UNF	0.6
250-500kg	0.5-1.5klb	50.8	60.96	18.03	21.41	M12 1/2-20UNF	0.6
1t	2-2.5klb	50.8	60.96	24.38	27.76	M12 1/2-20UNF	1
2.5t	3-5klb	76.2	99.06	24.38	27.76	M20 1/2-20UNF	1.5
5t	10klb	74.68	99.06	30.74	34.12	M20 3/4-16UNF	1.7
7.5t	15klb	87.38	139.7	37.08	40.46	M24 1-14UNF	2.2
10t	20klb	112.8	177.8	42.93	46.31	M30 5/4-12UNF	2.7

