

TechnicalData

Capacity 10 -500kg	Input Resistance 350 ± 3.5Ω
Sensitivity 2.0 ± 0.2mV/V	Output Resistance 350 ±3.5Ω
Accuracy C3 C4 C5	Insulation Resistance ≥5000mΩ
Non-Linearity 0.017%FS	Operating Tem Range -35...65 C
Non-Repeatability 0.01%FS	Safe Load 150% F.S.
Creep (30 Min) 0.02%FS	Ultimate Overload 300% F.S.
Zero Balance ± 1% Emax	Recommended Excitation 5-12VDC
TE Zero 0.017%FS/10 C	Protection: IP68
TE Span 0.014%FS/10 C	* TE=Temperature Effect

Features

- 17-4Ph stainless steel material
- Fully welded construction
- Comprehensive mounting holes
- IP68 | IP69K protection
- Capacity up to 500Kg
- Recommended platforms: 250x250mm to 800x800mm
- default of 3m Cable dia 5mm
- Customized cable available

Equivalent to the following models:

- HBM* PW15AH (100kg less)
- Zemic* BM6G

Mettler Toledo* SLP845 (100kg less)

*All those product names, logos, brands and other trademarks featured or referred to within this catalog are the property of their respective trademark holders.

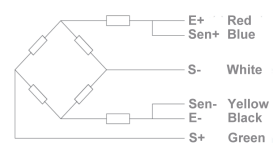

10-100kg dimension: mm

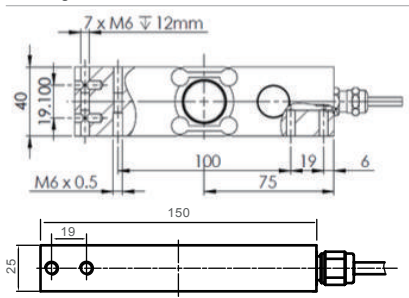

100-500kg dimension: mm

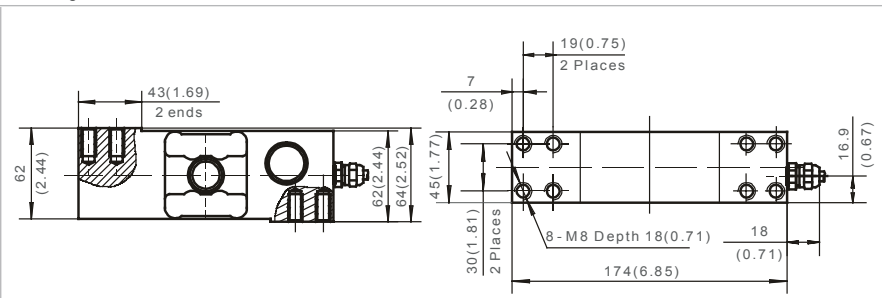

Models

Part No.	120093	120094	120095	120096	120097	120098	120099	120100
Models1	M17P-10	M17P-20	M17P-50	M17P-100	M17P-100L	M17P-200	M17P-300	M17P-500
U.P.(USD)	\$500.00	\$500.00	\$500.00	\$500.00	\$520.00	\$520.00	\$520.00	\$520.00
Capacity	10kg	20kg	50kg	100kg	100kg	200kg	300kg	500kg
Class					C3			
Weight	1kg				3kg			