

| d | d1 | d2 | d3 | h | L1 | L2 | B | C1 |
|------------|----|-------|----|-----|----|-----|----|------|
| M8 x 1.25 | 8 | 15.88 | 24 | 42 | 25 | 54 | 12 | 9 |
| M10 x 1.5 | 10 | 19.05 | 28 | 48 | 28 | 62 | 14 | 10.5 |
| M12 x 1.75 | 12 | 22.23 | 32 | 54 | 32 | 70 | 16 | 12 |
| M20 x 1.5 | 20 | 34.93 | 50 | 78 | 45 | 103 | 25 | 18 |
| M24 x 2 | 24 | 42.85 | 60 | 94 | 55 | 124 | 31 | 22 |
| M30 x 2 | 30 | 50.8 | 70 | 110 | 66 | 145 | 37 | 25 |



M3K

For M3 series load cells
 Alloy steel material
 Easy installation
 Sliding contact surface:
 steel/PTFE
 Rod body with zinc plated

Models

| Part No. | 120310 | 120311 | 120312 | 120313 | 120314 | 120315 |
|------------------|----------------|----------------|----------------|----------------|----------------|----------------|
| Models | M13K-M8 | M13K-M10 | M13K-M12 | M13K-M20 | M13K-M24 | M13K-M30 |
| U.P.(USD) | \$10.00 | \$16.00 | \$28.00 | \$48.00 | \$64.00 | \$88.00 |
| Max. | 1000kg | 1400kg | 1700kg | 4300kg | 6900kg | 8900kg |
| Weight | 0.04kg | 0.06kg | 0.85kg | 0.38kg | 0.64kg | 1.10kg |

* Max for dynamic lifting weight

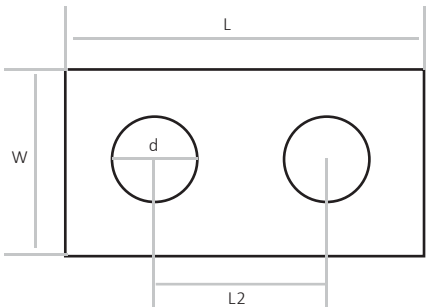

| Capacity | L | W | L2 | d |
|----------|-----|----|------|----|
| 0.5-2t | 54 | 32 | 25.4 | 14 |
| 2.5-5t | 76 | 38 | 38 | 20 |
| 10t | 102 | 51 | 50 | 27 |

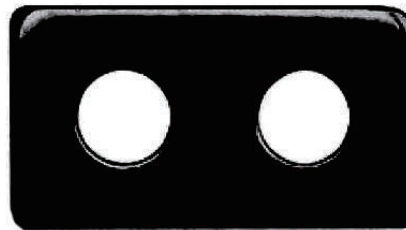

SP28

For M28 series load cells
 Alloy steel material
 Black painted or zinc coated
 Easy installation

Models

| Part No. | 120316 | 120317 | 120318 |
|------------------|---------------|---------------|---------------|
| Models | SP28-2 | SP28-5 | SP28-10 |
| U.P.(USD) | \$2.40 | \$4.80 | \$9.60 |
| Capacity | 0.5-2t | 2.5-5t | 10t |

CABLE

Cable4 - 4+1 shield cable
 Cable6 - 6+1 shield cable



Models

| Part No. | 120319 | 120320 |
|------------------|---------------|---------------|
| Models | CABLE4 | CABLE6 |
| U.P.(USD) | \$3.60 | \$4.80 |
| Wires | 4+1 | 6+1 |

* Price per meter